

INDEX

- ADAMS C-C-3
- ADCOCK DR C-C-3
- BELL CR C-C-3
- BELMONT DR C-C-3
- BIARWOOD CV C-C-3
- BRASSFIELD C-C-3
- BRENT C-C-3
- BRIARWOOD CR C-C-3
- BROOKHAVEN DR C-C-3
- CARLTON CR C-C-3
- CEDAR A-2-2
- CENTER RD A-2-2
- CHURCH A-2-2
- CLARK DR C-C-3
- CLAYTON DR C-C-3
- COURT C-C-3
- CRESTVIEW C-C-4
- CYPRESS C-C-2
- DAN GILL DR C-C-4
- DESHA DR C-C-3
- DING DONG DADDY BLVD C-C-3
- DUMARK DR C-C-3
- E BANKS C-C-3
- E BOWLES C-C-3
- E BURNETT C-C-3
- E CHOCTAW C-C-3
- E DANTE C-C-3
- E FARMER C-C-3
- E LEE C-C-3
- E POWELL C-C-3
- E PURYEAR C-C-3
- E WATERMAN C-C-3
- E WOLFE C-C-3
- EDWARDS DR A-2-2
- EMILY BOWEN DR C-C-4
- EVERGREEN C-C-4
- FREE DR C-C-4
- GENA A-A-1
- GOODLOW A-A-1
- GRANT A-A-1
- GREEN RD B-B-2
- HARRIS RD B-B-2
- HAWTHORNE PL C-C-4
- HENRY C-C-4
- HICKORY C-C-4
- HIGHWAY 65 C-C-3
- HIGHWAY 165 C-C-3
- INDUSTRIAL RD D-D-3
- JACK DANTE DR C-C-4
- JAN DR C-C-3
- JERRY C-C-3
- JOHN DR C-C-3
- JUDY C-C-3
- JULIANN CR A-2-2
- KELLEY A-2-2
- LENNOX CR C-C-3
- LONG C-C-3
- MAGNOLIA C-C-3
- MAY DR A-A-2
- MCCARRELL C-C-3
- MCKENON C-C-3
- MEADOR DR C-C-4
- MELROSE AVE C-C-4
- MILLER RD C-C-4
- MISTLETOE C-C-4
- MOHAWK DR C-C-3
- MULBERRY C-C-3
- N ASH C-C-3
- N BEECH C-C-3
- N BEECH C-C-3
- N CHERRY C-C-3
- N COLLEGE C-C-3
- N ELM C-C-3
- N HIGHWAY C-C-3
- N MAIN C-C-3
- N OAK C-C-3
- N PEACH C-C-3
- N PINE C-C-3
- N RAILROAD C-C-3
- N WALNUT C-C-3
- N WILLOW C-C-3
- NELSON C-C-3
- NORTH VIEW DR A-2-2
- OUTER DR A-2-2
- PALMETTO DR C-C-3
- PATRICK DR C-C-3
- PECAN C-C-3
- PETERSON C-C-3
- PICKENS C-C-3
- PISTACHIO DR C-C-3
- POMEGRANITE C-C-3
- PORTIS C-C-3
- RANKIN C-C-3
- REED RD C-C-3
- RICE PL C-C-3
- RINGO C-C-3
- ROBINWOOD DR C-C-3
- S ASH C-C-3
- S CHERRY C-C-3
- S COLLEGE C-C-3
- S ELM C-C-3
- S MAIN C-C-3
- S MAPLE C-C-3
- S OAK C-C-3
- S PEACH C-C-3
- S PINE C-C-3
- S RAILROAD C-C-3
- S WALNUT C-C-3
- S WILLOW C-C-3
- SHADY GROVE LN C-C-3
- SHERMAN C-C-3
- SHORT C-C-3
- SUMMIT DR C-C-3
- VINE C-C-3
- W BANKS C-C-3
- W BOWLES C-C-3
- W BURNETT C-C-3
- W CHOCTAW C-C-3
- W FARMER C-C-3
- W JONES C-C-3
- W KING C-C-3
- W PARK C-C-3
- W POWELL C-C-3
- W WATERMAN C-C-3

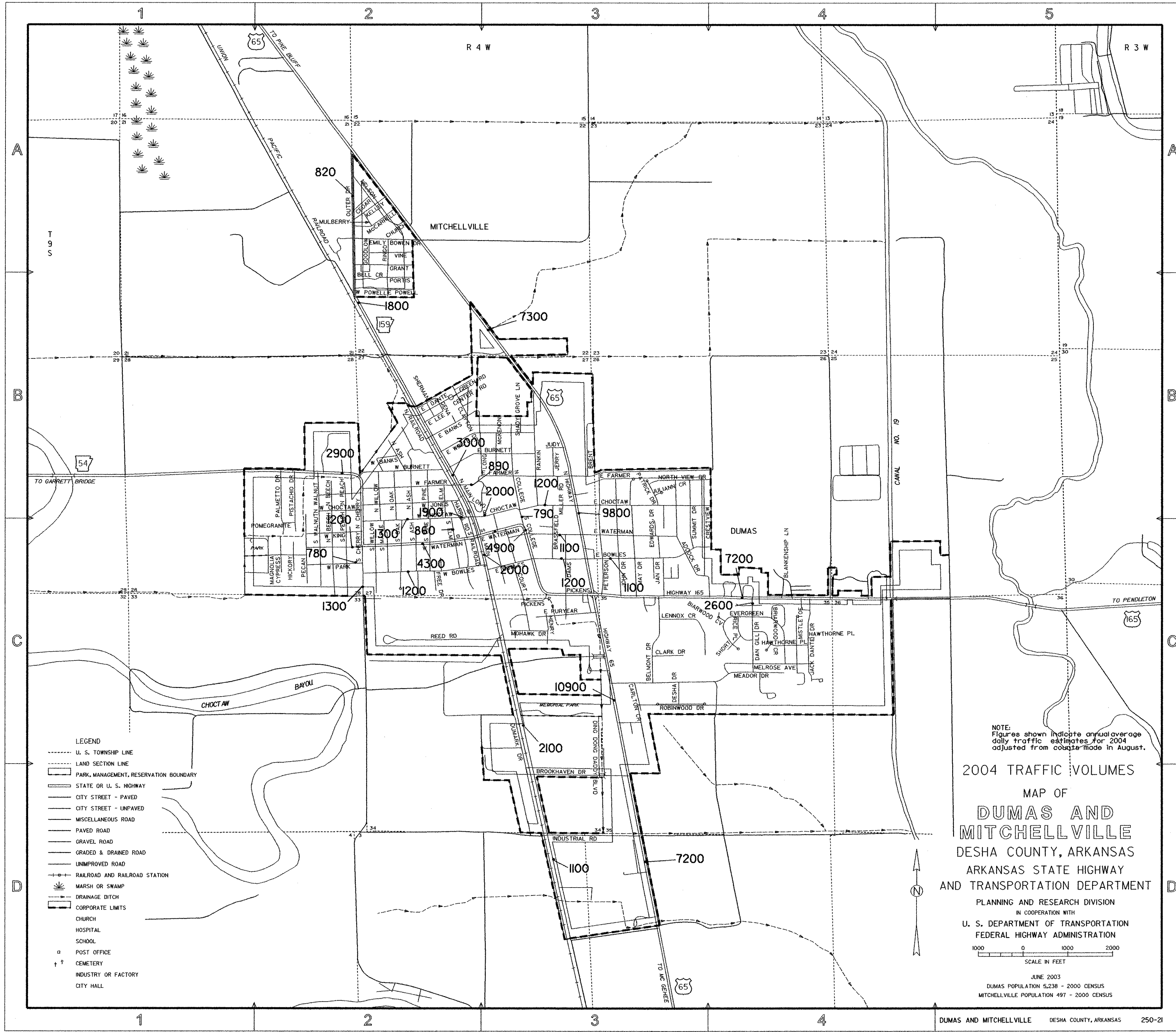

- LEGEND
- U. S. TOWNSHIP LINE
 - LAND SECTION LINE
 - PARK, MANAGEMENT, RESERVATION BOUNDARY
 - STATE OR U. S. HIGHWAY
 - CITY STREET - PAVED
 - CITY STREET - UNPAVED
 - MISCELLANEOUS ROAD
 - PAVED ROAD
 - GRAVEL ROAD
 - GRADED & DRAINED ROAD
 - UNIMPROVED ROAD
 - RAILROAD AND RAILROAD STATION
 - MARSH OR SWAMP
 - DRAINAGE DITCH
 - CORPORATE LIMITS
 - CHURCH
 - HOSPITAL
 - SCHOOL
 - o POST OFFICE
 - + † CEMETERY
 - INDUSTRY OR FACTORY
 - CITY HALL

NOTE:
 Figures shown indicate annual average
 daily traffic estimates for 2004
 adjusted from counts made in August.

2004 TRAFFIC VOLUMES
 MAP OF
**DUMAS AND
 MITCHELLVILLE**
 DESHA COUNTY, ARKANSAS
 ARKANSAS STATE HIGHWAY
 AND TRANSPORTATION DEPARTMENT

PLANNING AND RESEARCH DIVISION
 IN COOPERATION WITH
 U. S. DEPARTMENT OF TRANSPORTATION
 FEDERAL HIGHWAY ADMINISTRATION

1000 0 1000 2000
 SCALE IN FEET

JUNE 2003
 DUMAS POPULATION 5,238 - 2000 CENSUS
 MITCHELLVILLE POPULATION 497 - 2000 CENSUS