

INDEX

- 3 RD AVE
- "A"
- AIRPORT RD
- ARNOLD
- ASH
- "B"
- BAILEY
- BEMIS
- BRYANT
- "C"
- CALE RD
- CALE RD
- CEDAR
- CORNELIUS
- DALTON AVE
- DE ANN
- E 2 ND N
- E 2 ND S
- E 3 RD N
- E 3 RD S
- E 4 TH N
- E 4 TH S
- E 5 TH N
- E 5 TH S
- E 6 TH N
- E 6 TH S
- E 7 TH N
- E 7 TH S
- E 8 TH S
- CHESTNUT
- ELM
- FIRST N
- FIRST S
- HAZEL
- LAUREL
- MAIN
- OLIVE
- PINE
- ROSS
- VINE
- WALNUT
- ELIZABETH
- FAIR GROUNDS RD
- FLEMING AVE
- FRIAR TUCK
- GARLAND
- GEE
- GREENLAWN
- GULLEY
- HALE AVE
- HALE DR
- HALE LN
- HALL
- HATLEY AVE
- HAYS
- HIGHMEADOW
- HINDS BLVD
- HOLLY
- JAMES
- JONES
- JOYCE
- KATHRYN
- MANOR RD
- MARR
- MARRION RD
- MARTIN
- MILL
- MOCKINGBIRD LN
- MONCHIEF
- MONSON
- MOORE HWY
- MOORE HWY
- MYRTLE
- NOTTINGHAM
- OAK
- OAK GROVE
- OZAN AVE
- PEARL AVE
- PECAN
- POWELL
- RIDGEWOOD RD
- ROLLING HILL
- ROSTON RD
- SCHOOL
- SCOTT
- SECTION LINE AVE
- SHERWOOD DR
- STEWART RD
- VICKS AVE
- W 2 ND
- W 3 ND N
- W 3 ND S
- W 3 RD N
- W 3 RD S
- W 4 TH N
- W 4 TH S
- W CHESTNUT
- W ELM
- W FIRST
- W FIRST S
- W HAZEL
- W LAUREL
- W MAIN
- W MAIN
- W OLIVE
- W PINE
- W WALNUT
- WARREN
- WASHINGTON RD
- WEBB
- WHITESIDE
- WILCAT RD
- WILSON

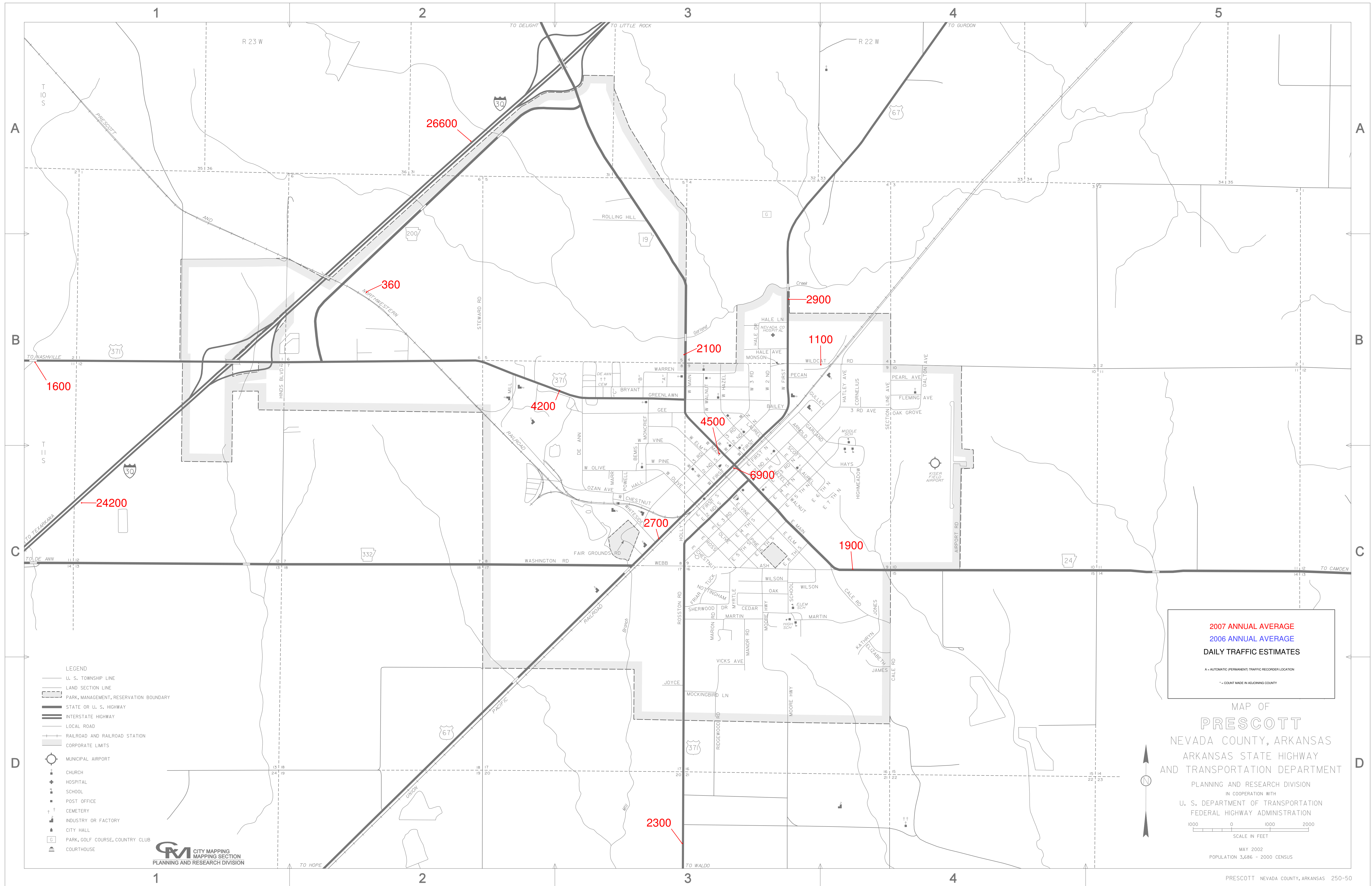

- LEGEND**
- U. S. TOWNSHIP LINE
 - LAND SECTION LINE
 - ▨ PARK, MANAGEMENT, RESERVATION BOUNDARY
 - ▬ STATE OR U. S. HIGHWAY
 - ▬ INTERSTATE HIGHWAY
 - ▬ LOCAL ROAD
 - ⊕ RAILROAD AND RAILROAD STATION
 - ▭ CORPORATE LIMITS
 - ⊙ MUNICIPAL AIRPORT
 - ⊕ CHURCH
 - ⊕ HOSPITAL
 - ⊕ SCHOOL
 - ⊕ POST OFFICE
 - ⊕ CEMETERY
 - ⊕ INDUSTRY OR FACTORY
 - ⊕ CITY HALL
 - ⊕ PARK, GOLF COURSE, COUNTRY CLUB
 - ⊕ COURTHOUSE

CITY MAPPING
 MAPPING SECTION
 PLANNING AND RESEARCH DIVISION