



# INFORMATION RELEASE

## Office of the Director

ARKANSAS STATE HIGHWAY AND TRANSPORTATION DEPARTMENT  
P. O. Box 2261 – Little Rock, Arkansas  
Telephone (501) 569-2227

ArkansasHighways.com  
Twitter: @AHTD

**Contact:**  
**Danny Straessle**

**NR 15-325**  
**September 11, 2015**

### **CONSTRUCTION REQUIRES LANE CLOSURE ON STATE HIGHWAY 338 AT GEYER SPRINGS INTERSECTION IN LITTLE ROCK**

**LITTLE ROCK (9-11)** – Construction associated with a new CVS Pharmacy in the southwest corner of the intersection of State Highway 338 (Baseline Road) and Geyer Springs Road will require temporary lane closures beginning today, according to Arkansas State Highway and Transportation Department (AHTD) officials.

A contractor working for CVS Pharmacy will construct a new driveway and curb and gutter for the new retail location. The work will require closing the eastbound right-turn lane at the intersection that allows traffic to turn southbound onto Geyer Springs Road. See attached map.

**Work will begin today, Friday, September 11 and will continue for the next seven days. The lane closure will only take place between 9:00 a.m. and 3:00 p.m. on those days.** Traffic will be controlled using warning signs and traffic cones.

Drivers should exercise caution when approaching and traveling through all highway work zones. Additional travel information can be found at [IDriveArkansas.com](http://IDriveArkansas.com) or [ArkansasHighways.com](http://ArkansasHighways.com). You can also follow us on [Twitter @AHTD](https://twitter.com/AHTD).



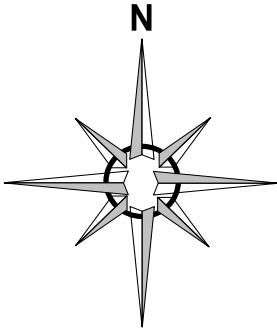

Baseline Rd.

Geyer Springs Rd.



500 ft

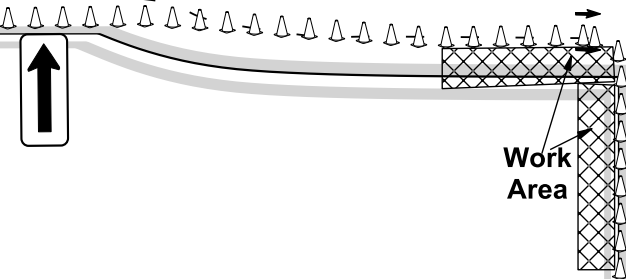

Work Area

